

Learn More
www.olgparish.org/aom

Contact
Jon Cassady, Director of Advancement,
at joncassady@olgparish.org
or 952-929-3317 (x9054).



Preschool Parish Activity Center Link Building

Groundbreaking April 9, 2021



ADVANCING OUR MISSION CONSTRUCTION PHASES

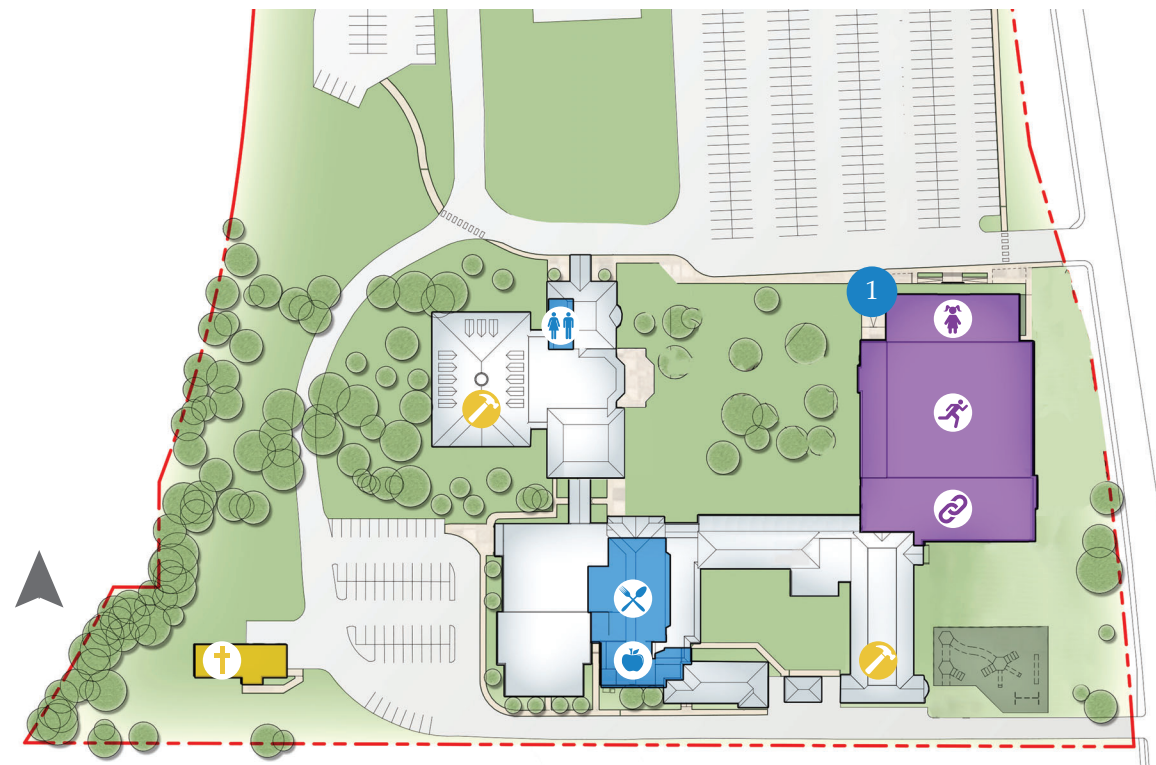

- Phase 1**
- Campus Enhancements/Maintenance
 - Priest Residence

- Phase 2**
- Parish Activity Center
 - Preschool
 - Link Building

- Phase 3**
- Kitchen
 - Cafeteria
 - Restroom Improvements



1 Main Entrance

1ST FLOOR

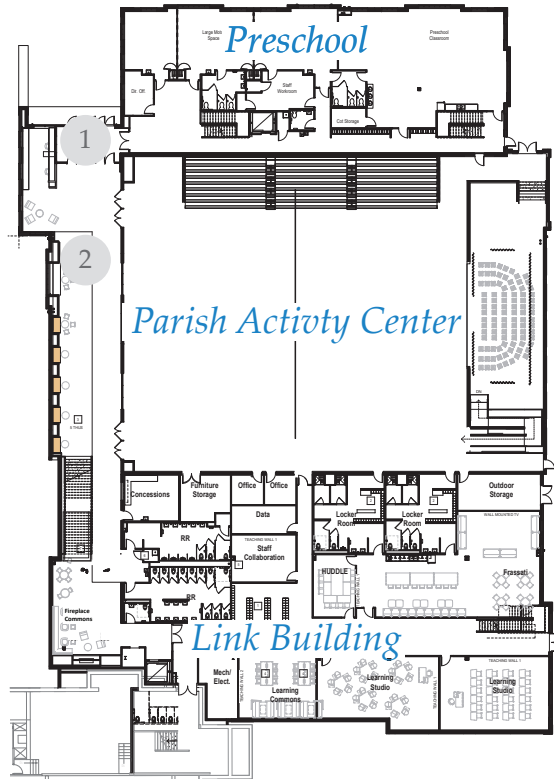

2ND FLOOR

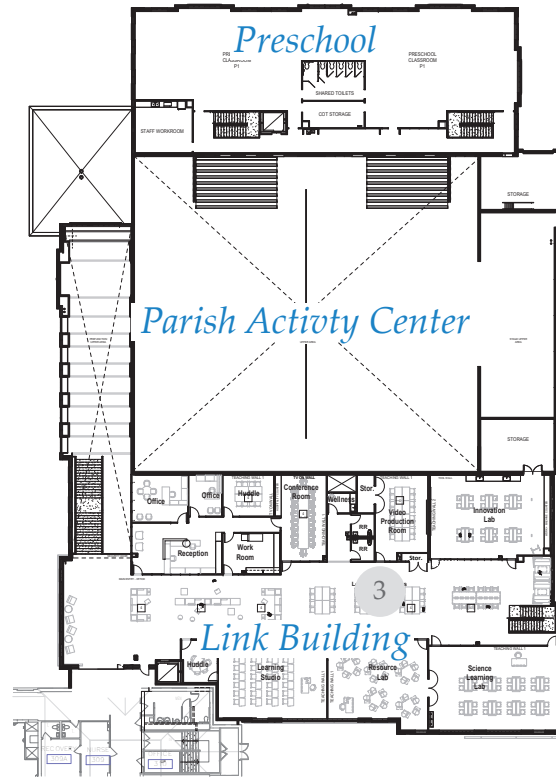

Preschool

The new preschool will be located at the front of the Activity Center, close to the parking lot, and will have learning space for up to 120 children, ages 33 months to 5 years old.

Parish Activity Center

The Parish Activity Center will be a multi-purpose space built on the old rectory site. The Parish Activity Center will house a new full-size gym with a performing arts stage. The lobby space, which will line the inner courtyard wall of the gym, will serve as the main entrance for the school including a reception area and space to display trophies.

The gym, which will be divisible into two smaller gyms, will include bleachers, a dividing wall, locker room, equipment storage, a concession/spirit store, and office space.

The performing arts stage will be a permanent stage on the long side of the gym with auxiliary space for music equipment, costumes, make-up, and props.

Link Building

The Link Building will consist of rooms paralleling the lower and main level of the school linking the existing building to the Parish Activity Center. The new space will include classrooms, a new Frassati (youth) Room, multi-purpose atrium and innovative learning spaces.



ADVANCING OUR MISSION

In 2019 with the leadership and assistance of OLG staff and parish volunteers, we prepared a Master Plan which represented the facilities through which we envision Advancing Our Mission for the next 75 years.

OLG seeks to have an even greater impact by fostering more engagement, connectivity, and participation in our parish and educational community and beyond. The overall campaign goal is set for \$26 Million.

For more information about these capital enhancements, major construction, or updates on the AOM campaign, please visit the OLG Advancing Our Mission webpage at www.olgparish.org/aom.

Thank You!

OLG is deeply grateful for the generosity of all those who have contributed to this campaign, making these projects possible! The completion of this construction phase is projected for late summer of 2022.



1 Security/Check-In



2 Entrance Lobby



3 Innovative Learning Space